



CompTIA

220-1101 Exam

CompTIA A+ Certification Exam Core 1 Exam

Exam Latest Version: 39.9

DEMO Version

Full Version Features:

- 90 Days Free Updates
- 30 Days Money Back Guarantee
- Instant Download Once Purchased
- 24 Hours Live Chat Support

Full version is available at link below with affordable price.

<https://www.directcertify.com/comptia/220-1101>

Question 1. (Single Select)

Which of the following would an administrator use to migrate virtual machines from on premises to the cloud?

- A: IaaS
- B: SaaS
- C: DBaaS
- D: DRaaS

Correct Answer: A

Explanation:

An administrator would use Infrastructure as a Service (IaaS) to migrate virtual machines from on-premises to the cloud. IaaS is a cloud computing service that provides virtualized computing resources, such as servers, storage, and networking, that can be used to deploy and run applications in the cloud. By using IaaS, an administrator can create a virtual machine in the cloud and migrate the existing virtual machine from on-premises to the cloud. CompTIA A+ Certification Exam: Core 1 - Objective 3.3

Question 2. (Multi Select)

A user requested upgrades to a company-issued laptop to increase its performance while working with a large database stored on drive C. Which of the following tasks should a systems administrator complete to BEST meet this goal? (Select TWO).

- A: Configure RAID 1.
- B: Install a hybrid drive.
- C: Upgrade to 1GB NI
- D: Increase the RAM.
- E: Migrate to a SSD.
- F: Upgrade the power supply.

Correct Answer: D, E

Explanation:

To increase the performance of a laptop working with a large database stored on drive C, a systems administrator should increase the RAM and migrate to an SSD. Increasing the RAM will help the laptop to better handle the large database, while migrating to an SSD will improve the speed at which the laptop can access the database. Configuring RAID 1, installing a hybrid drive, upgrading to a 1GB NIC, and upgrading the power supply will not directly improve the laptop's performance when working with a large database. CompTIA A+ Certification Exam: Core 1 - Objective 3.1

Question 3. (DRAGDROP)

An office manager reports that a printer is experiencing performance issues. Printouts are smudging when they are handled, and, recently, whenever the manager tries to print oversized documents, the paper jams before anything is printed on it.



Correct Answer:



Question 4. (HOTSPOT)

A customer built a computer for gaming, sourcing individual components and then assembling the system. The OS starts up, but within a few minutes the machine locks up. The customer brought the computer to a technician to diagnose the issue.

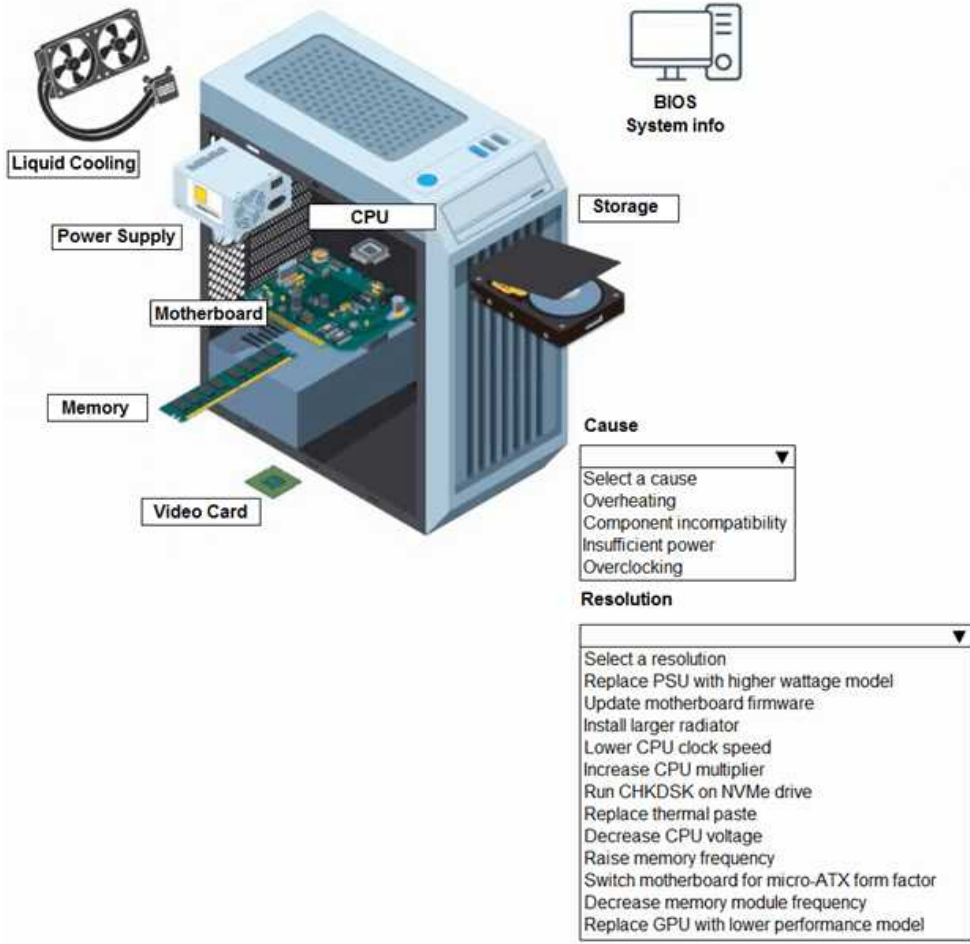

Correct Answer:

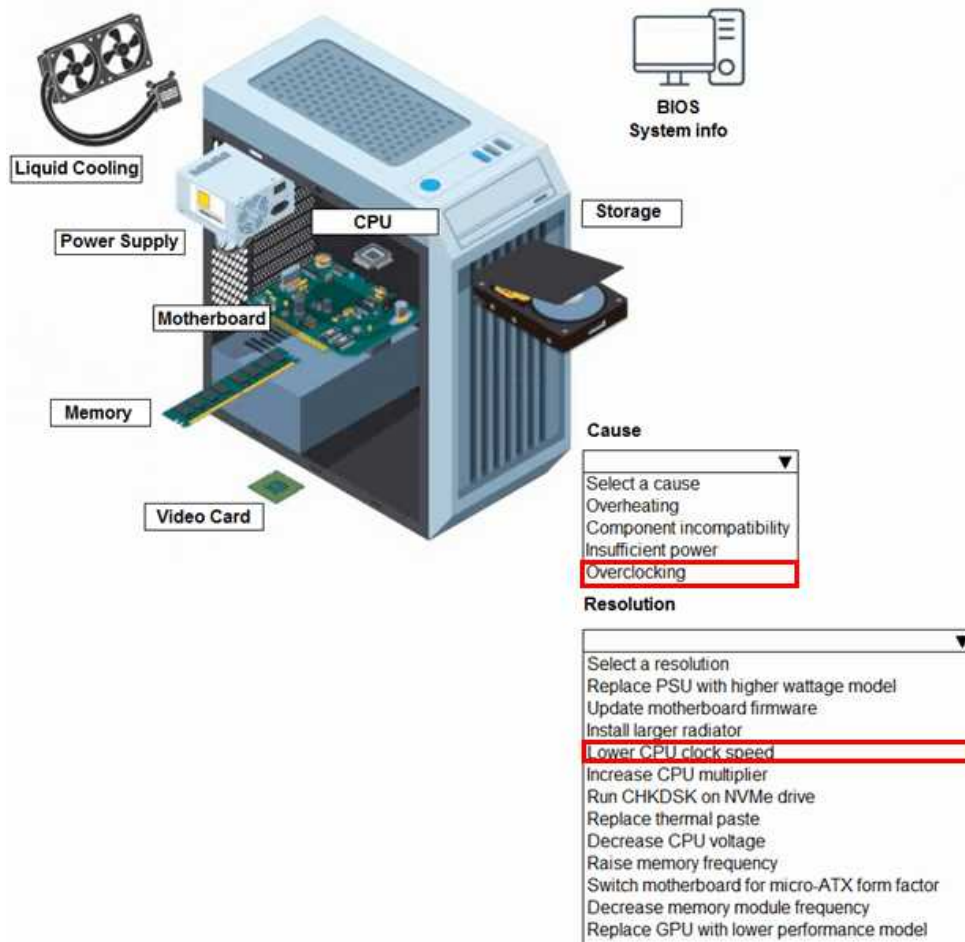

Question 5. (Single Select)

A company just bought a printer capable of automatically printing on both sides of the paper. After installation, however, the technician can only print on both sides of the paper manually. Which of the following should the technician do to fix the issue?

- A: Install the most recent firmware upgrade available for the printer.
- B: Contact the vendor for a hardware replacement.
- C: Reinstall the printer software and drivers, and then restart the printer.
- D: Read the installation manual and configure duplex settings.

Correct Answer: D

Explanation:

The issue described in the question is most likely due to an incorrect configuration of the printer's duplex settings. To enable automatic duplex printing, the technician needs to read the printer's installation manual to understand how to configure the printer's duplex settings correctly. Once the settings are configured, the printer should be able to print on both sides of the paper automatically.

To fix the issue of a newly installed printer capable of automatically printing on both sides of the paper but only printing on both sides manually, the technician should read the installation manual and configure duplex settings. Duplex printing settings can be configured in the printer driver software, which can be accessed through the printer settings in the Control Panel. Installing the most recent firmware upgrade available for the printer, contacting the vendor for a hardware replacement, or reinstalling the printer software and drivers and restarting the printer will not resolve the issue.



Full version is available at link below with affordable price.

<https://www.directcertify.com/comptia/220-1101>

30% Discount Coupon Code: LimitedTime2025

*** 100% MONEY BACK GUARANTEED**
CERTIFICATION EXAMS
STUDY GUIDES

PDF
FREE TRIAL

*** Product Features**

- * 100% Success in the Final Exam
- * 90 Days Free Updates
- * Latest Exam Q/A
- * 24/7 Customer Support
- * Practice Exams

*** Free Demo for Practice Test & PDF**

50K Plus Satisfied Customers

VISA AMERICAN EXPRESS DISCOVER G Pay